

PART NO. DP350

SPECIFICATIONS	
INPUT VOLTS	12 VDC - 240 VDC
OUTPUT SPEED	7-1200 RPM.
OUTPUT TORQUE	UP TO 350 IN-LBS, CONTINUOUS
GEAR RATIO	5:1 TO 264:1
SHAFT DIA "ØD"	Ø.625 STD, UP TO Ø.750
SHAFT EXT. "S"	AS REQUIRED
SHAFT FEATURE	FLAT, KEYWAY, OR AS REQUIRED
MOUNTING	FACE, FOOT, OR AS REQUIRED
BRUSHES	INTERNAL BRUSH CARD, OR REPLACEABLE BRUSHES
LEAD WIRES	AS REQUIRED
BEARINGS	BALL BEARING, OUTPUT BEARING SUPPORT ON INPUT SHAFT
INSULATION	UL CLASS H
MOTOR TYPE	SERIES DM32 OR DM40

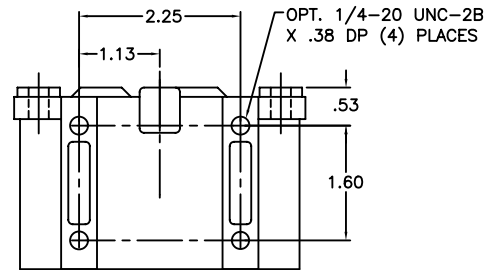
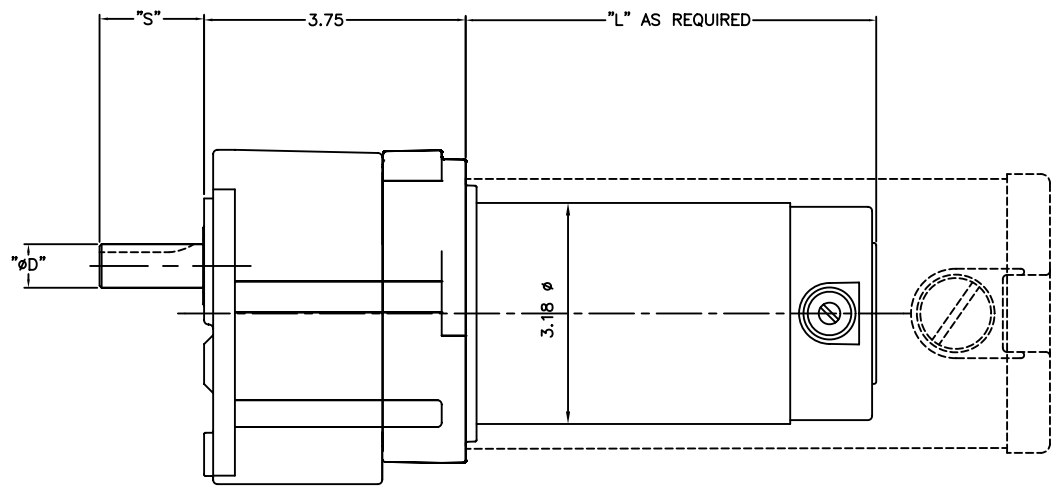
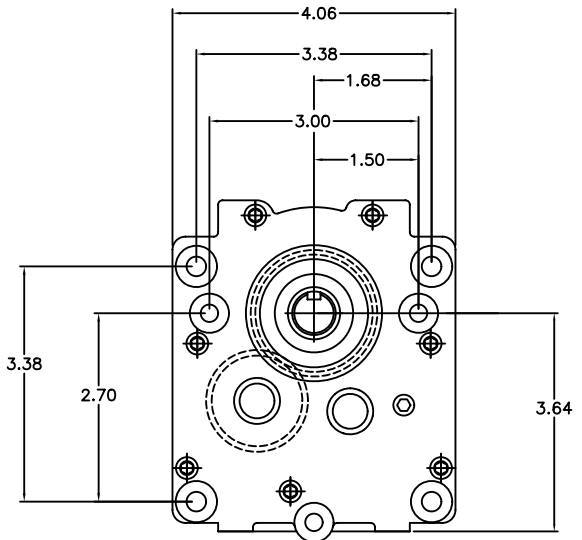

MOUNTING TYPICAL TOP AND BOTTOM

USE:

DESIGN APPROVAL	DATE	UNSPECIFIED TOLERANCES .xxx ±.005 .xx ±.015 .x ±.050 Machine Finish Angles ±1° Concentricity .005 TIR Squareness .001 per in.	This Drawing is the property of the Dumore Corporation. It must not be reproduced or copied without written permission.		PART NO.	DP350
DESIGN					DUMORE CORPORATION	1030 VETERAN ST. MAUSTON, WI 53948
MFG. ENG.					TITLE 3.2" PARALLEL SHAFT GEARMOTOR	
Q.C.					DO NOT SCALE DRAWING	REMOVE ALL BURRS BREAK SHARP CORNERS
SALES		MATERIAL SPEC.	RECEIVED AS	DATE	SCALE	