

STANDARD PERFORMANCE				
VOLTS	RPM	AMPS	DUTY	FT-LB
115 VDC	7	20	CONT.	1000
OPTIONAL FEATURES				
INPUT VOLTS	12 VDC - 240 VDC			
OUTPUT SPEED	2 RPM - 1500 RPM			
OUTPUT TORQUE	UPTO 1000 FL-LB			
GEAR RATIO	1355.91:1 AT 4 STAGES; 3, 2, OR 1 STAGES AS REQUIRED			
SHAFT DIA. "Ø D"	Ø 1.781 OR AS REQUIRED			
SHAFT EXT. "S"	1.8" OR AS REQUIRED			
SHAFT FEATURE	KEYWAY, FLAT, OR AS REQUIRED			
MOUNTING	FACE, FOOT OR AS REQUIRED			
BRUSHES	INTERNAL; REPLACABLE			
LEAD WIRES	16/12 AWG, END WITH TERMINATION AS REQUIRED			
BEARINGS	ONE WAY CLUTCH BEARINGS			
INSULATION	UL CLASS H			
MOTOR TYPE	SERIES DM40			

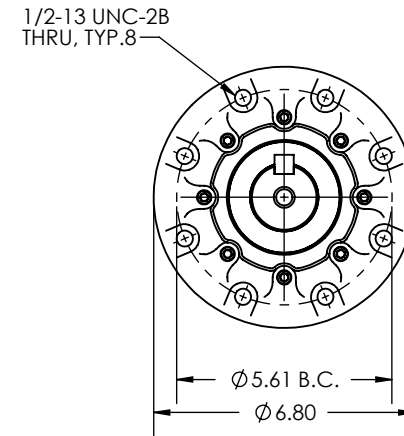

REV.	DESCRIPTION	DATE	ECN
DESIGN APPROVAL	UNSPECIFIED TOLERANCES		
DES. ENG.	.XXX ± .005		
MFG. ENG.	.XX ± .015		
Q.C.	.X ± .050		
SALES	MACHINE FINISH ± 1°		
	ANGLES .005 TIR		
	CONCENTRICITY .001 PER IN.		
	SQUARENESS		
DO NOT SCALE DRAWING	REMOVE ALL BURRS BREAK SHARP CORNERS	TITLE	
MATERIAL SPEC.	RECEIVED AS	4" PLANETARY GEAR MOTOR	
	Req. per Piece	DWG. BY	DATE
	Pattern No.	CKD. BY	DATE
			SCALE
			1:5

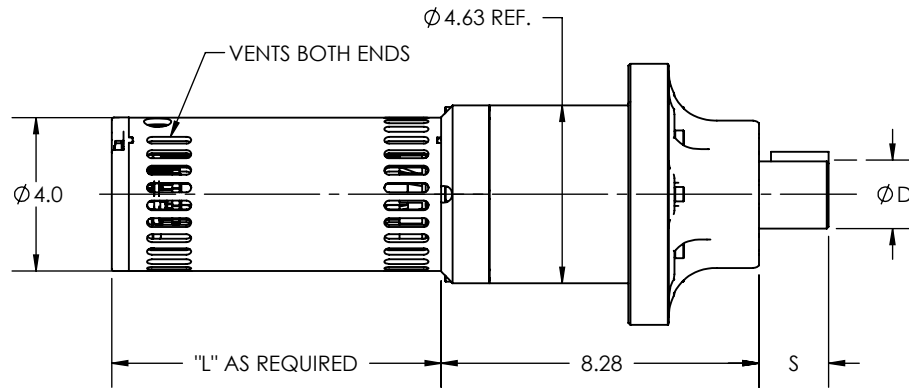

PART NO.

DPL1000

DUMORE CORPORATION

1030 VETERANS ST. MAUSTON, WI 53948

This Drawing is the property of the Dumore Corporation. It must not be reproduced or copied without written permission.