

OPTIONAL FEATURES	
INPUT VOLTS	12 VDC / 230 VDC
OUTPUT SPEED	3 RPM / 1000 RPM
OUTPUT TORQUE	UP TO 1000 FT-LB
GEAR RATIO	7:1 - 1350:1
LENGTH "L"	5.60 / 8.75
SHAFT DIA. "Ø D"	UP TO Ø 2.00
SHAFT EXT. "S"	AS REQUESTED
SHAFT FEATURE	HOB, KEYWAY, FLAT, OR AS REQUESTED
MOUNTING	FLANGE MOUNT, FOOT MOUNT
BRUSHES	INTERNAL; REPLACEABLE
LEAD WIRES	AS REQUESTED
BEARINGS	BALL OR TAPERED ROLLER
VENTING	ENCLOSED / VENTED / FAN COOLED
INSULATION	UL CLASS H
MOTOR TYPE	SERIES DM40

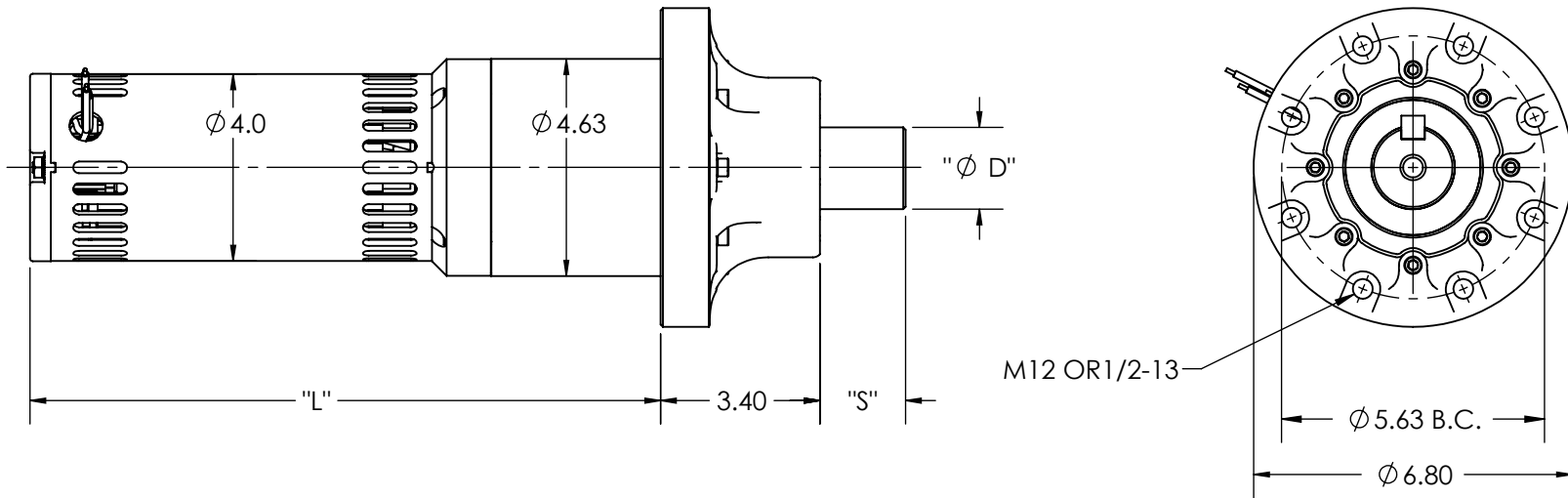

REV.	DESCRIPTION	DATE	ECN
DESIGN APPROVAL	UNSPECIFIED TOLERANCES		
DES. ENG.	.XXX ± .005		
MFG. ENG.	.XX ± .015		
Q.C.	.X ± .050		
SALES	MACHINE FINISH ± 1°		
	ANGLES .005 TIR		
	CONCENTRICITY .001 PER IN.		
	SQUARENESS		
DO NOT SCALE DRAWING	REMOVE ALL BURRS BREAK SHARP CORNERS	TITLE	
MATERIAL SPEC.	RECEIVED AS	PLANETARY GEAR MOTOR	
	Req. per Piece	DWG. BY	DATE
	Pattern No.	CRD. BY	DATE
			SCALE
			1:4

This Drawing is the property of the Dumore Corporation. It must not be reproduced or copied without written permission.

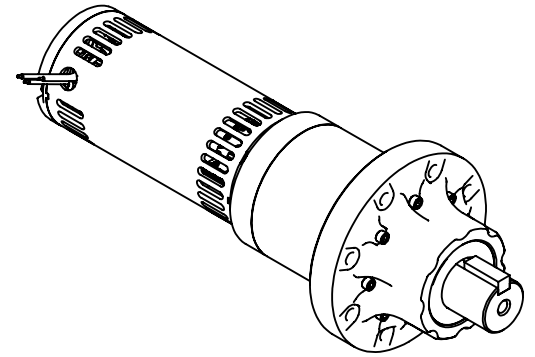

PART NO.
DPL1000
DUMORE CORPORATION
1030 VETERANS ST. MAUSTON, WI 53948